

Piñones 5 x 2,5 mm 03-1

para cadenas de
rodillos
segun DIN 8187
ISO/R 606

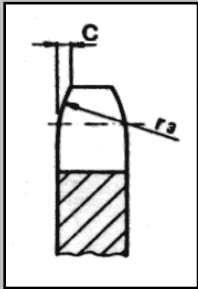

Piñon	
mm	
Radio diente r_3	
5	
Ancho Radio C	
0,4	
Ancho Diente piñ. B_1	
2,3	
Cadena	
mm	
Paso	
5	
Ancho Interna	
2,5	
Rodillo	
3,2	
Material Fe 50	

z	de	dp	S			D			T		
			dm	D1	A	dm	D2	A	dm	D3	A
8	14.8	13.06	7	4	10						
9	16.4	14.62	8	5	10						
10	17.9	16.18	9	5	10						
11	19.5	17.75	11	6	10						
12	21.1	19.32	12	6	10						
13	22.6	20.89	14	6	10						
14	24.2	22.47	15	6	10						
15	25.8	24.04	16	6	10						
16	27.4	25.63	18	8	13						
17	29.0	27.20	18	8	13						
18	30.5	28.79	18	8	13						
19	32.1	30.38	18	8	13						
20	33.7	31.96	18	8	13						
21	35.3	33.54	20	8	13						
22	36.9	35.13	20	8	13						
23	38.5	36.72	20	8	13						
24	40.1	38.30	20	8	13						
25	41.6	39.89	20	8	13						
26	43.2	41.48	25	8	15						
27	44.8	43.07	25	8	15						
28	46.4	44.65	25	8	15						
29	48.0	46.25	25	8	15						
30	49.6	47.83	25	8	15						
31	51.2	49.42	30	8	15						
32	52.8	51.01	30	8	15						
33	54.4	52.60	30	8	15						
34	55.9	54.19	30	8	15						
35	57.5	55.78	30	8	15						
36	59.1	57.37	30	8	15						
37	60.7	58.96	30	8	15						
38	62.3	60.54	30	8	15						
39	63.9	62.13	30	8	15						
40	65.5	63.73	30	8	15						

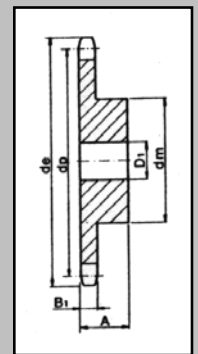

Piñones	z	de	dp	S			D			T		
				dm	D1	A	dm	D2	A	dm	D3	A
6 x 2,8 mm 04-1	8	18.0	15.67	9.8	5	10						
	9	19.9	17.54	11.5	5	10						
	10	21.7	19.42	13	6	10						
	11	23.6	21.30	14	6	10						
para cadenas de												

rodillos
segun DIN 8187
ISO/R 606

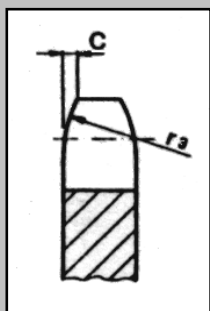

Piñon

mm

Radio diente r_3

6

Ancho Radio C

0,6

Ancho Diente pin.

B_1 2,6

Cadena

mm

Paso

6

Ancho Interno

2,8

Rodillo

4

Material Fe 50

12	25.4	23.18	16	6	10
13	27.3	25.05	18	6	10
14	29.2	26.96	20	6	10
15	31.1	28.86	20	6	10
16	33.0	30.76	20	8	13
17	35.0	32.65	20	8	13
18	36.9	34.55	20	8	13
19	38.8	36.44	20	8	13
20	40.7	38.34	20	8	13
21	42.6	40.25	25	8	13
22	44.5	42.16	25	8	13
23	46.4	44.06	25	8	13
24	48.3	45.96	25	8	13
25	50.2	47.87	25	8	13
26	52.1	49.77	30	8	15
27	54.0	51.67	30	8	15
28	55.9	53.58	30	8	15
29	57.8	55.50	30	8	15
30	59.8	57.42	30	8	15
31	61.7	59.31	30	10	15
32	63.6	61.21	30	10	15
33	65.5	63.11	30	10	15
34	67.4	65.02	30	10	15
35	69.3	66.93	30	10	15
36	71.2	68.84	30	10	15
37	73.1	70.75	30	10	15
38	75.0	72.66	30	10	15
39	76.9	74.56	30	10	15
40	78.9	76.47	30	10	15
45	88.5	86.01	62	12	18
50	98.0	95.55	62	12	18
57	111.4	108.9	62	12	18

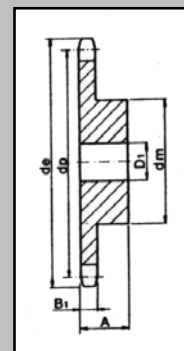

Telefono: (00 34) 93 719 05 57
 Fax: (00 34) 93 718 24 43
 C./ Circunvalacion, 45 08210
 BARBERA DEL VALLES (Barcelona)
 ESPAÑA
 Correo electronico:
administracio@wedatransmisiones.com

catálogo general

[VOLVER AL INDICE](#)

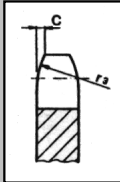
	z	de	dp	S			D			T		
				dm	D1	A	dm	D2	A	dm	D3	A
Piñones 8 x 3,0 mm 05B - 1 - 2 para cadenas de rodillos según DIN 8187 ISO/R 606 	8	23.4	20.90	13	6	12	12	6	18			
	9	25.9	23.39	15	6	12	15	6	18			
	10	28.4	25.89	17	6	12	17	8	18			
	11	31.0	28.39	18	7	13	19	8	18			
	12	33.7	30.91	20	7	13	21	8	18			
	13	36.7	33.42	23	7	13	24	8	18			
	14	39.2	35.95	25	7	13	26	8	18			
	15	41.7	38.48	28	7	13	29	8	18			
	16	44.2	41.01	30	8	14	32	10	20			
	17	46.7	43.53	30	8	14	34	10	20			
	18	49.2	46.07	30	8	14	37	10	20			
	19	51.7	48.61	30	8	14	39	10	20			
	20	54.2	51.14	30	8	14	40	10	20			
	21	57.2	53.67	35	8	14	45	12	20			
	22	59.4	56.21	35	8	14	45	12	20			
	23	62.2	58.75	35	8	14	45	12	20			
	24	64.7	61.29	35	8	14	45	12	20			
	25	67.2	63.83	35	8	14	45	12	20			
	26	69.7	66.37	40	10	16	50	12	22			
	27	72.3	68.91	40	10	16	50	12	22			
28	74.7	71.45	40	10	16							
29	77.2	73.99	40	10	16							
30	80.2	76.53	40	10	16	50	12	22				
31	82.7	79.08	40	12	16							
32	85.2	81.61	40	12	16	60	12	22				
33	87.7	84.16	40	12	16							
34	90.2	86.70	40	12	16							
35	92.7	89.24	40	12	16	60	12	22				
36	95.2	91.79	40	12	16	60	12	22				
37	97.7	94.33	40	12	16							
38	100.2	96.88	40	12	16	60	12	22				
39	102.7	99.42	40	12	16							
40	105.7	101.97	40	12	16	60	12	22				
45	118.6	114.69	60	12	20							
50	131.5	127.41	60	12	20							
57	149.3	145.22	80	14	20							

Piñon	mm
Radio diente r_3	8
Ancho Radio C	0,8
Ancho Diente pn. B_1	2,8
Ancho Diente pin. b_1	2,7
Ancho Diente pin. B_2	8,3

Cadena	mm
Paso	8
Ancho Interna	3
Rodillo	5

Material Fe 50

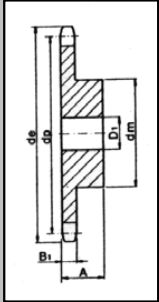

z	de	dp	S			D			T		
			dm	D1	A	dm	D2	A	dm	D3	A

Piñones

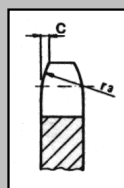
3/8" x 7/32"**9,525 x 5,72 mm**
06B - 1 - 2 - 3para cadenas de rodillos
segun DIN 8187
ISO/R 606

Piñon mm

Radio diente r_3 10

Ancho Radio C 1

Ancho Diente pin. B_1 5,3Ancho Diente pin. b_1 5,2Ancho Diente pin. B_2 15,4Ancho Diente pin. B_3 25,6

Cadena mm

Paso 9,525

Ancho Interno 5,72

Rodillo 6,35

Material C 43

*Material Fe 50

8	26.8	24.89	15	8	20	15	8	25	15	8	32
9	31.5	27.85	18	8	20	18	8	25	18	8	32
10	34.5	30.82	20	8	20	20	8	25	20	10	32
11	37.5	33.80	22	8	25	22	10	30	22	12	35
12	40.5	36.80	25	8	25	25	10	30	25	12	35
13	43.5	39.80	28	8	25	28	10	30	28	12	35
14	46.5	42.80	31	8	25	31	10	30	31	12	35
15	49.5	45.81	34	8	25	34	10	30	34	12	35
16	52.5	48.82	37	10	28	37	12	30	37	12	35
17	55.5	51.83	40	10	28	40	12	30	40	12	35
18	58.6	54.85	43	10	28	43	12	30	43	12	35
19	61.6	57.87	45	10	28	46	12	30	46	12	35
20	64.6	60.89	46	10	28	49	12	30	49	12	35
21	67.6	63.91	48	12	28	52	16	30	52	16	40
22	70.6	66.93	50	12	28	55	16	30	55	16	40
23	73.7	66.95	52	12	28	58	16	30	58	16	40
24	76.7	72.97	54	12	28	61	16	30	61	16	40
25	79.7	76.00	57	12	28	64	16	30	64	16	40
26	82.7	79.02	60	12	28	67	16	30	67	16	40
27	85.7	82.04	60	12	28	70	16	30	70	16	40
28	88.8	85.07	60	12	28	73	16	30	73	16	40
29	91.8	88.09	60	12	28	76	16	30	76	16	40
30	94.8	91.12	60	12	30	79	16	30	79	16	40
31	97.9	94.15	68	14	30	80	16	30	80	16	40
32	100.9	97.17	68	14	30	80	16	30	80	16	40
33	103.9	100.20	68	14	30	80	16	30	80	16	40
34	106.9	103.23	68	14	30	80	16	30	85	16	40
35	110.0	106.26	68	14	30	80	16	30	85	16	40
36	113.0	109.29	70	16	30	90	16	30	90	16	40
37	116.0	112.32	70	16	30	90	16	30	90	16	40
38	119.0	115.34	70	16	30	90	16	30	90	16	40
39	122.1	118.37	70	16	30	90	16	30	90	16	40
40	125.1	121.40	70	16	30	90	16	30	90	16	40
42	132.1	127.46	*78	16	35	*88	20	50			
45	141.1	136.54	*78	16	35	*88	20	50	*88	16	60
46	144.2	139.58	*78	16	35						
48	150.2	145.64	*78	16	35	*88	20	50			
50	156.3	151.69	*78	20	35	*88	20	50	*88	20	60
55	171.4	166.85	*78	20	35						
57	177.5	172.91	*78	20	35	*88	20	50	*88	25	60
60	186.6	181.99	*78	20	35	*88	20	50	*88	25	60
76	235.1	230.49	*78	20	35	*88	25	50	*88	25	60
95	292.7	288.08	*88	25	40	*108	25	50	*120	25	60

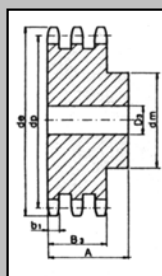
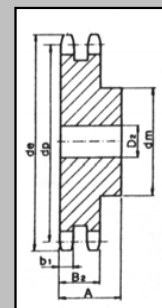
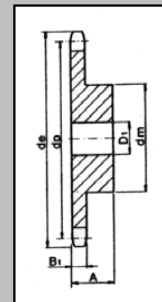

Telefono: (00 34) 93 719 05 57
 Fax: (00 34) 93 718 24 43
 C./ Circunvalacion, 45 08210
 BARBERA DEL VALLES (Barcelona)
 ESPAÑA
 Correo electronico:
administracio@wedatransmisiones.com

catálogo general

[VOLVER AL INDICE](#)

**Piñones
1/2" x 1/8"
12,7 x 3,3 mm
081 - 1**

para cadenas de rodillos
segun DIN 8187
ISO/R 606

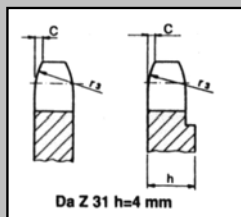

Piñon	mm
Radio diente r ₃	13
Ancho Radio C	0,8
Ancho Diente pin. B ₁	3
Cadena	mm
Paso	12,7
Ancho Interno	3,3
Rodillo	7,75
Material C-43	

z	de	dp	S			D			T		
			dm	D1	A	dm	D2	A	dm	D3	A
8	39.5	33.18	21	8	14						
9	43.4	37.13	25	8	14						
10	47.4	41.10	28	8	14						
11	51.4	45.07	31	8	16						
12	55.4	49.07	35	8	16						
13	59.4	53.06	39	8	16						
14	63.4	57.07	43	8	16						
15	67.4	61.09	47	8	16						
16	71.4	65.10	50	10	18						
17	75.4	69.11	50	10	18						
18	79.4	73.14	50	10	18						
19	83.5	77.16	50	10	18						
20	87.5	81.19	50	10	18						
21	91.5	85.22	60	12	20						
22	95.5	89.24	60	12	20						
23	99.6	93.27	60	12	20						
24	103.6	97.29	60	12	20						
25	107.6	101.33	60	12	20						
26	111.7	105.36	70	16	20						
27	115.7	109.40	70	16	20						
28	119.7	113.42	70	16	20						
29	123.8	117.46	70	16	20						
30	127.8	121.50	70	16	20						
31	131.8	125.54									
32	135.9	129.56	70	16	20						
33	139.9	133.60									
34	143.9	137.64	70	16	20						
35	148.0	141.68	70	16	20						
36	152.0	145.72	70	16	25						
37	156.1	149.76	70	16	25						
38	160.1	153.80	70	16	25						
39	164.1	157.83	70	16	25						
40	168.2	161.87	70	16	25						

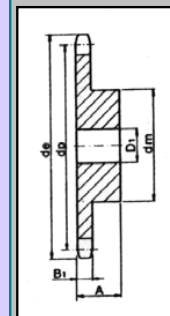

**Piñones
1/2" x 3/16"
12,7 x 4,88 mm
083-1/084-1**

para cadenas de rodillos
segun DIN 8187
ISO/R 606

z	de	dp	S			D			T		
			dm	D1	A	dm	D2	A	dm	D3	A
8	39.5	33.18	21	8	14						
9	43.4	37.13	25	8	14						
10	47.4	41.10	28	8	14						
11	51.4	45.07	31	8	16						
12	55.4	49.07	35	8	16						
13	59.4	53.06	39	8	16						
14	63.4	57.07	43	8	16						
15	67.4	61.09	47	8	16						
16	71.4	65.10	50	10	18						

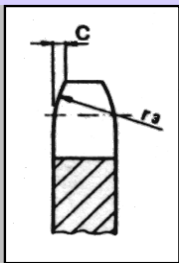

Piñon mm
 Radio diente r_3 13
 Ancho Radio C 1,3
 Ancho Diente pin. B_1 4,5
 Cadena mm
 Paso 12,7
 Ancho Interno 4,88
 Rodillo 7,75
 Material C-43

17	75.4	69.11	50	10	18
18	79.4	73.14	50	10	18
19	83.5	77.16	50	10	18
20	87.5	81.19	50	10	18
21	91.5	85.22	60	12	20
22	95.5	89.24	60	12	20
23	99.6	93.27	60	12	20
24	103.6	97.29	60	12	20
25	107.6	101.33	60	12	20
26	111.7	105.36	70	16	20
27	115.7	109.40	70	16	20
28	119.7	113.42	70	16	20
29	123.8	117.46	70	16	20
30	127.8	121.50	70	16	20
31	131.8	125.54	70	16	20
32	135.9	129.56	70	16	20
33	139.9	133.60	70	16	20
34	143.9	137.64	70	16	20
35	148.0	141.68	70	16	20
36	152.0	145.72	70	16	25
37	156.1	149.76	70	16	25
38	160.1	153.80	70	16	25
39	164.1	157.83	70	16	25
40	168.2	161.87	70	16	25

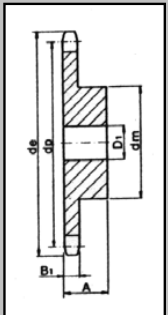

Telefono: (00 34) 93 719 05 57
 Fax: (00 34) 93 718 24 43
 C./ Circunvalacion, 45 08210
 BARBERA DEL VALLES (Barcelona)
 ESPAÑA
 Correo electronico:
administracio@wedatransmisiones.com

catálogo general

[VOLVER AL INDICE](#)

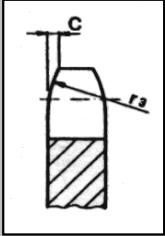
	z	de	dp	S			D			T		
				dm	D1	A	dm	D2	A	dm	D3	A
Piñones 1/2" x 1/4" 12,7 x 6,4 x 7,75 mm 085 - 1 para cadenas de rodillos segun DIN 8187 ISO/R 606 	8	39.5	33.18									
	9	43.4	37.13	24	10	25						
	10	47.4	41.10									
	11	51.4	45.07	29	10	25						
	12	55.4	49.07									
	13	59.4	53.06									
	14	63.4	57.07									
	15	67.4	61.09									
	16	71.4	65.10									
	17	75.4	69.11									
	18	79.4	73.14									
	19	83.5	77.16	60	12	28						
	20	87.5	81.19									
	21	91.5	85.22	68	14	28						
	22	95.5	89.24									
	23	99.6	93.27	70	14	28						
	24	103.6	97.29									
	25	107.6	101.33									
	26	111.7	105.36	70	16	30						
	27	115.7	109.40									
	28	119.7	113.42	70	16	30						
	29	123.8	117.46									
	30	127.8	121.50									
	31	131.8	125.54									
	32	135.9	129.56									
	33	139.9	133.60	90	16	30						
	34	143.9	137.64	90	16	30						
	35	148.0	141.68									
	36	152.0	145.72	90	16	35						
	37	156.1	149.76	90	16	35						
	38	160.1	153.80									
	39	164.1	157.83									
	40	168.2	161.87	90	16	35						

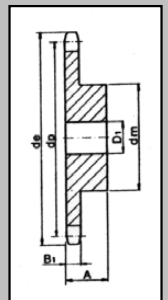

	z	de	dp	S			D			T		
				dm	D1	A	dm	D2	A	dm	D3	A
Piñones 1/2" x 1/4" 12,7 x 6,4 x 8,51 mm para cadenas de rodillos segun DIN 8187 ISO/R 606	8	38.0	33.18									
	9	42.0	37.13									
	10	45.9	41.10	26	10	25						
	11	49.9	45.07	29	10	25						
	12	53.9	49.07									
	13	57.9	53.06									
	14	61.9	57.07									
	15	65.9	61.09	45	10	28						
	16	69.9	65.10	50	12	28						
	17	74.0	69.11									

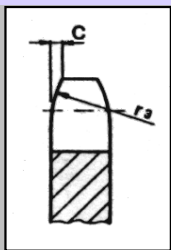

18	78.0	73.14			
19	82.0	77.16	60	12	28
20	86.0	81.19	64	12	28
21	90.1	85.22	68	14	28
22	94.1	89.24	70	14	28
23	98.1	93.27	70	14	28
24	102.1	97.29	70	14	28
25	106.2	101.33	70	14	28
26	110.2	105.36			
27	114.2	109.40			
28	118.3	113.42	70	16	30
29	122.3	117.46			
30	126.3	121.50	80	16	30
31	130.4	125.54			
32	134.4	129.56			
33	138.4	133.60			
34	142.4	137.64			
35	146.5	141.68			
36	150.6	145.72			
37	154.6	149.76			
38	158.6	153.80			
39	162.7	157.83			
40	166.7	161.87			

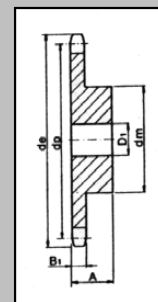

Piñon mm

Radio diente r_3 13

Ancho Radio C 1,3

Ancho Diente pin. B_1 5,9

Cadena mm

Paso 12,7

Ancho Interno 6,4

Rodillo 8,51

Material C-43



Telefono: (00 34) 93 719 05 57
 Fax: (00 34) 93 718 24 43
 C./ Circunvalacion, 45 08210
 BARBERA DEL VALLES (Barcelona)
 ESPAÑA
 Correo electronico:
administracio@wedatransmisiones.com

catálogo general

[VOLVER AL INDICE](#)

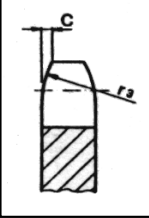
		z	de	dp	S			D			T		
					dm	D1	A	dm	D2	A	dm	D3	A
Piñones 1/2" x 5/16" 12,7 x 7,75 mm 08B - 1 - 2 - 3 para cadenas de rodillos segun DIN 8187 ISO/R 606 		8	38.0	33.18	20	10	25	20	10	32	20	10	46
		9	42.0	37.13	24	10	25	24	10	32	24	12	46
		10	45.9	41.10	26	10	25	28	10	32	28	12	46
		11	49.9	45.07	29	10	25	32	12	35	32	16	50
		12	53.9	49.07	33	10	28	35	12	35	35	16	50
		13	57.9	53.06	37	10	28	38	12	35	38	16	50
		14	61.9	57.07	41	10	28	42	12	35	42	16	50
		15	65.9	61.09	45	10	28	46	12	35	46	16	50
		16	69.9	65.10	50	12	28	50	16	38	50	16	50
		17	74.0	69.11	52	12	28	54	16	38	54	16	50
		18	78.0	73.14	56	12	28	58	16	38	58	16	50
		19	82.0	77.16	60	12	28	62	16	38	62	16	50
		20	86.0	81.19	64	12	28	66	16	38	66	16	50
		21	90.1	85.22	68	14	28	70	16	40	70	16	55
		22	94.1	89.24	70	14	28	70	16	40	70	16	55
		23	98.1	93.27	70	14	28	70	16	40	70	16	55
		24	102.1	97.29	70	14	28	75	16	40	75	16	55
		25	106.2	101.33	70	14	28	80	16	40	80	16	55
		26	110.2	105.36	70	16	30	85	16	40	85	20	55
		27	114.2	109.40	70	16	30	85	16	40	85	20	55
28	118.3	113.42	70	16	30	90	16	40	90	20	55		
29	122.3	117.46	80	16	30	95	16	40	95	20	55		
30	126.3	121.50	80	16	30	100	16	40	100	20	55		
31	130.4	125.54	90	16	30	100	20	40	100	20	55		
32	134.4	129.56	90	16	30	100	20	40	100	20	55		
33	138.4	133.60	90	16	30	100	20	40	100	20	55		
34	142.4	137.64	90	16	30	100	20	40	100	20	55		
35	146.5	141.68	90	16	30	100	20	40	100	20	55		
36	150.6	145.72	90	16	35	100	20	40	100	25	55		
37	154.6	149.76	90	16	35	100	20	40	100	25	55		
38	158.6	153.80	90	16	35	100	20	40	100	25	55		
39	162.7	157.83	90	16	35	100	20	40	100	25	55		
40	166.7	161.87	90	16	35	100	20	40	100	25	55		
42	176.5	169.95	*88	20	42	*108	20	55					
45	188.6	182.07	*88	20	42	*108	20	55	*120	25	68		
46	192.6	186.10	*88	20	42	*108	20	55					
48	200.7	194.18	*88	20	42	*108	20	55					
50	208.8	202.26	*88	20	42	*108	20	55	*136	25	68		
55	229.0	222.46	*88	20	42								
57	237.1	230.54	*88	20	42	*108	25	55	*120	25	68		
60	249.2	242.66	*88	20	42	*108	25	55	*120	25	68		
76	313.9	307.33	*88	25	42	*108	25	55	*120	30	68		
95	390.7	384.11	*108	25	42	*120	25	55	*136	30	68		

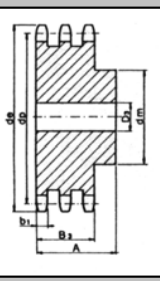
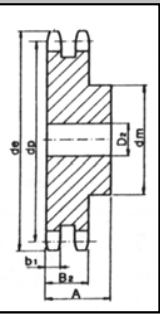
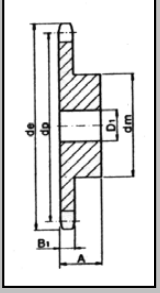

		z	de	dp	S			D			T		
					dm	D1	A	dm	D2	A	dm	D3	A
Piñones 5/8" x 3/8" 15,875 x 9,65 mm		8	48.4	41.08	25	10	25	25	12	40	25	12	55
		9	53.3	46.42	30	10	25	30	12	40	30	12	55
		10	58.3	51.37	35	10	25	35	12	40	35	16	55
		11	63.2	56.34	37	12	30	39	16	40	39	16	55

10B - 1 - 2 - 3

para cadenas de rodillos
segun DIN 8187
ISO/R 606

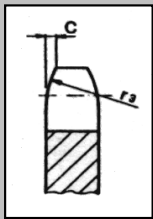

Pinon mm

Radio diente r₃ 16

Ancho Radio C 1,6

Ancho Diente pin. B₁ 9,1

Ancho Diente pin.b₁ 9

Ancho Diente pin.B₂ 25,5

Ancho Diente pin.B₃ 42,1

Cadena mm

Paso 15,875

Ancho Interno 9,65

Rodillo 10,16

Material C-43

Material Fe

12	68.2	61.34	42	12	30	44	16	40	44	16	55
13	73.2	66.32	47	12	30	49	16	40	49	16	55
14	78.2	71.34	52	12	30	54	16	40	54	16	55
15	83.2	76.36	57	12	30	59	16	40	59	16	55
16	88.3	81.37	60	12	30	64	16	45	64	16	60
17	93.3	86.39	60	12	30	69	16	45	69	16	60
18	98.3	91.42	70	14	30	74	16	45	74	16	60
19	103.3	96.45	70	14	30	79	16	45	79	16	60
20	108.4	101.49	75	14	30	84	16	45	84	16	60
21	113.4	106.52	75	16	30	85	16	45	85	20	60
22	118.4	111.55	80	16	30	90	16	45	90	20	60
23	123.5	116.58	80	16	30	95	16	45	95	20	60
24	128.5	121.62	80	16	30	100	16	45	100	20	60
25	133.6	126.66	80	16	30	105	16	45	105	20	60
26	138.6	131.70	85	20	35	110	20	45	110	20	60
27	143.6	136.75	85	20	35	110	20	45	110	20	60
28	148.7	141.78	90	20	35	115	20	45	115	20	60
29	153.7	146.83	90	20	35	115	20	45	115	20	60
30	158.8	151.87	90	20	35	120	20	45	120	20	60
31	163.8	156.92	95	20	35	120	20	45	120	20	60
32	168.9	161.95	95	20	35	120	20	45	120	20	60
33	173.9	167.00	95	20	35	120	20	45	120	20	60
34	178.9	172.05	95	20	35	120	20	45	120	20	60
35	184.0	177.10	95	20	35	120	20	45	120	20	60
36	189.0	182.15	100	20	35	120	20	45	120	25	60
37	194.1	187.20	100	20	35	120	20	45	120	25	60
38	199.1	192.24	100	20	35	120	20	45	120	25	60
39	204.2	197.29	100	20	35	120	20	45	120	25	60
40	209.2	202.34	100	20	35	120	20	45	120	25	60
42	220.8	212.44	*108	20	43	120	25	59			
45	236.0	227.58	*108	20	43	*120	25	59	*136	25	74
46	241.0	236.63	*108	20	43	*120	25	59			
48	251.1	242.73	*108	20	43	*120	25	59			
50	261.2	252.82	*108	20	43	*120	25	59	*136	25	74
55	286.5	287.08	*108	20	43						
57	296.6	288.18	*108	25	43	*120	25	59	*136	25	74
60	311.7	303.32	*108	25	43	*120	25	59	*136	25	74
76	392.5	384.16	*108	25	43	*120	25	59	*145	30	75
95	488.5	480.14	*118	30	59	*145	30	59	*145	30	75

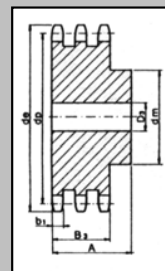
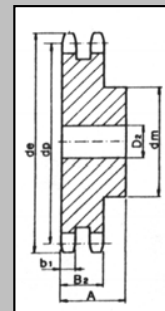
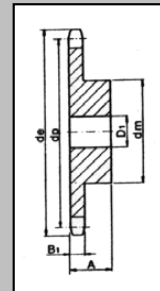

Telefono: (00 34) 93 719 05 57
Fax: (00 34) 93 718 24 43
C./ Circunvalacion, 45 08210
BARBERA DEL VALLES (Barcelona)
ESPAÑA

Correo electronico:
administracio@wedatransmisiones.com

catálogo general

[VOLVER AL INDICE](#)

Piñones
3/4" x 7/16"
19,05 x 11,68 mm
12B - 1 - 2 - 3

para cadenas de rodillos
 segun DIN 8187
 ISO/R 606

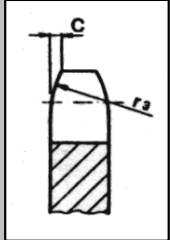

	z	de	dp	S			D			T			
				dm	D1	A	dm	D2	A	dm	D3	A	
	8	58.0	49.78	31	12	30	31	12	45	31	16	65	
	9	63.9	55.70	37	12	30	37	12	45	37	16	65	
	10	69.8	61.64	42	12	30	42	12	45	42	16	65	
	11	75.8	67.61	46	16	35	47	12	50	47	20	70	
	12	81.8	73.60	51	16	35	53	16	50	53	20	70	
	13	87.8	79.59	58	16	35	59	16	50	59	20	70	
	14	93.8	85.61	64	16	35	65	16	50	65	20	70	
	15	99.8	91.63	70	16	35	71	16	50	71	20	70	
	16	105.8	97.65	75	16	35	77	20	50	77	20	70	
	17	111.9	103.67	80	16	35	83	20	50	83	20	70	
	18	117.9	109.71	80	16	35	89	20	50	89	20	70	
	19	123.9	115.75	80	16	35	95	20	50	95	20	70	
	20	130.0	121.78	80	16	35	100	20	50	100	20	70	
	21	136.0	127.82	90	20	40	100	20	50	100	20	70	
	22	142.0	133.86	90	20	40	100	20	50	100	20	70	
	23	148.1	139.90	90	20	40	110	20	50	110	20	70	
Piñon	mm	24	154.1	145.94	90	20	40	110	20	50	110	20	70
		25	160.2	152.00	90	20	40	120	20	50	120	20	70
Radio diente r ₃	19	26	166.2	158.04	95	20	40	120	20	50	120	20	70
		27	172.3	164.09	95	20	40	120	20	50	120	20	70
Ancho Radio C	2	28	178.3	170.13	95	20	40	120	20	50	120	20	70
		29	184.4	176.19	95	20	40	120	20	50	120	20	70
Ancho Diente pin. B ₁	11,1	30	190.4	182.25	95	20	40	120	20	50	120	20	70
		31	196.5	188.31	95	20	40	120	20	50	130	25	70
Ancho Diente pin. b ₁	10,8	32	202.5	194.35	95	20	40	120	20	50	130	25	70
		33	208.6	200.40	95	20	40	120	20	50	130	25	70
Ancho Diente pin. B ₂	30,3	34	214.6	206.46	95	20	40	120	20	50	130	25	70
		35	220.7	212.52	95	20	40	120	20	50	130	25	70
Ancho Diente pin. B ₃	49,8	36	226.8	218.58	100	20	40	120	25	50	130	25	70
		37	232.8	224.64	100	20	40	120	25	50	130	25	70
Cadena	mm	38	238.9	230.69	100	20	40	120	25	50	130	25	70
		39	244.9	236.75	100	20	40	120	25	50	130	25	70
Paso	19,05	40	251.0	242.81	100	20	40	120	25	50	130	25	70
		42	265.0	254.93	*118	25	61	*136	25	62			
Ancho Interno	11,68	45	283.2	273.10	*118	25	61	*136	25	62	*140	25	72
		46	289.2	279.16	*118	25	61	*136	25	62			
Rodillo	12,07	48	301.4	291.27	*118	25	61	*136	25	62			
		50	313.5	303.39	*118	25	61	*136	25	62	*140	25	72
		55	343.8	333.70	*118	25	61						
Material C 43		57	355.9	345.81	*118	25	61	*136	25	62	*140	30	75
Material Fe		60	374.1	363.99	*118	25	61	*136	25	62	*140	30	75
		76	471.1	460.99	*118	30	61	*145	30	63	*150	30	75
		95	586.2	576.17	*133	30	62	*145	30	63	*150	30	75

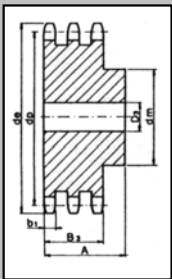
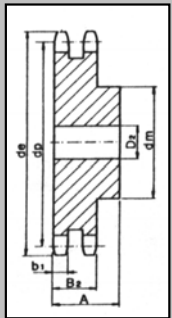
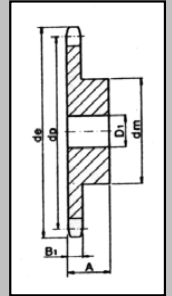

z	de	dp	S			D			T		
			dm	D1	A	dm	D2	A	dm	D3	A

Piñones
1" x 17,02 mm
25,4 x 17,02 mm
16B -1 - 2 - 3

para cadenas de rodillos
 segun DIN 8187
 ISO/R 606

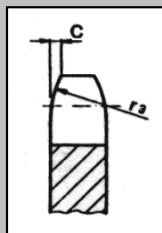

Piñon	mm		
Radio diente r_3	26		
Ancho Radio C	2,5		
Ancho Diente pin. B_1	16,2		
Ancho Diente pin. b_1	15,8		
Ancho Diente pin. B_2	47,7		
Ancho Diente pin. B_3	79,6		
Cadena	mm		
Paso	25,4		
Ancho Interno	17,02		
Rodillo	15,88		
Material C43			
Material Fe			

8	77.9	66.37	42	16	35	42	20	65	42	20	95
9	85.8	74.27	50	16	35	50	20	65	50	20	95
10	93.8	82.19	55	16	35	56	20	65	56	20	95
11	101.7	90.14	61	16	40	64	20	70	64	25	100
12	109.7	98.14	69	16	40	72	20	70	72	25	100
13	117.7	106.12	78	16	40	80	20	70	80	25	100
14	125.7	114.15	84	16	40	88	20	70	88	25	100
15	133.7	122.17	92	16	40	96	20	70	96	25	100
16	141.8	130.20	100	20	45	104	20	70	104	25	100
17	149.8	138.22	100	20	45	112	20	70	112	25	100
18	157.8	146.28	100	20	45	120	20	70	120	25	100
19	165.9	154.33	100	20	45	128	20	70	128	25	100
20	173.9	162.38	100	20	45	130	20	70	130	25	100
21	182.0	170.43	110	20	50	130	25	70	130	25	100
22	190.1	178.48	110	20	50	130	25	70	130	25	100
23	198.1	186.53	110	20	50	130	25	70	130	25	100
24	206.2	194.59	110	20	50	130	25	70	130	25	100
25	214.2	202.66	110	20	50	130	25	70	130	25	100
26	222.3	210.72	120	20	50	130	25	70	130	30	100
27	230.4	218.79	120	20	50	130	25	70	130	30	100
28	238.4	226.85	120	20	50	130	25	70	130	30	100
29	246.5	234.92	120	20	50	130	25	70	130	30	100
30	254.6	243.00	120	20	50	130	25	70	130	30	100
31	262.6	251.08	120	25	50	140	25	70	140	30	100
32	270.7	259.13	120	25	50	140	25	70	140	30	100
33	278.8	267.21	120	25	50	140	25	70	140	30	100
34	286.9	275.28	120	25	50	140	25	70	140	30	100
35	294.9	283.36	120	25	50	140	25	70	140	30	100
36	303.0	291.44	120	25	50	140	25	70	140	30	100
37	311.1	299.51	120	25	50	140	25	70			
38	319.2	307.59	120	25	50	140	25	70	140	30	100
39	327.2	315.67	120	25	50	140	25	70			
40	335.3	323.73	120	25	50	140	25	70	140	30	100
42	353.7	339.90	*133	25	68	*140	25	70			
45	377.9	364.12	*133	25	68	*140	25	70	*160	30	110
46	386.0	372.21	*133	25	68	*140	25	70			
48	402.1	388.36	*133	25	68	*140	25	70			
50	418.3	404.52	*133	25	68	*140	25	70	*160	30	110
57	474.9	461.07	*133	30	68	*160	40	82	*180	40	112
60	499.1	485.32	*133	30	68	*160	40	82			
76	628.4	614.65	*145	30	68	*160	40	82	*180	40	112
95	782.0	768.22	*160	30	78	*180	40	109	*180	40	112

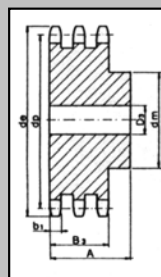
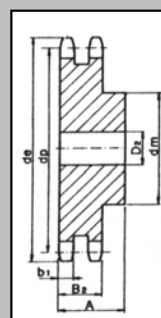
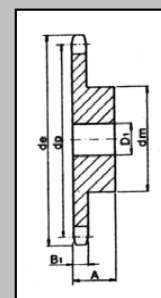

Telefono: (00 34) 93 719 05 57
 Fax: (00 34) 93 718 24 43
 C./ Circunvalacion, 45 08210
 BARBERA DEL VALLES (Barcelona)
 ESPAÑA
 Correo electronico:
administracio@wedatransmisiones.com

catálogo general

[VOLVER AL INDICE](#)